

**ST. BERNARD'S  
PARISH**

*"A Community of  
Good Stewards"*

# *Building Together With Christ*

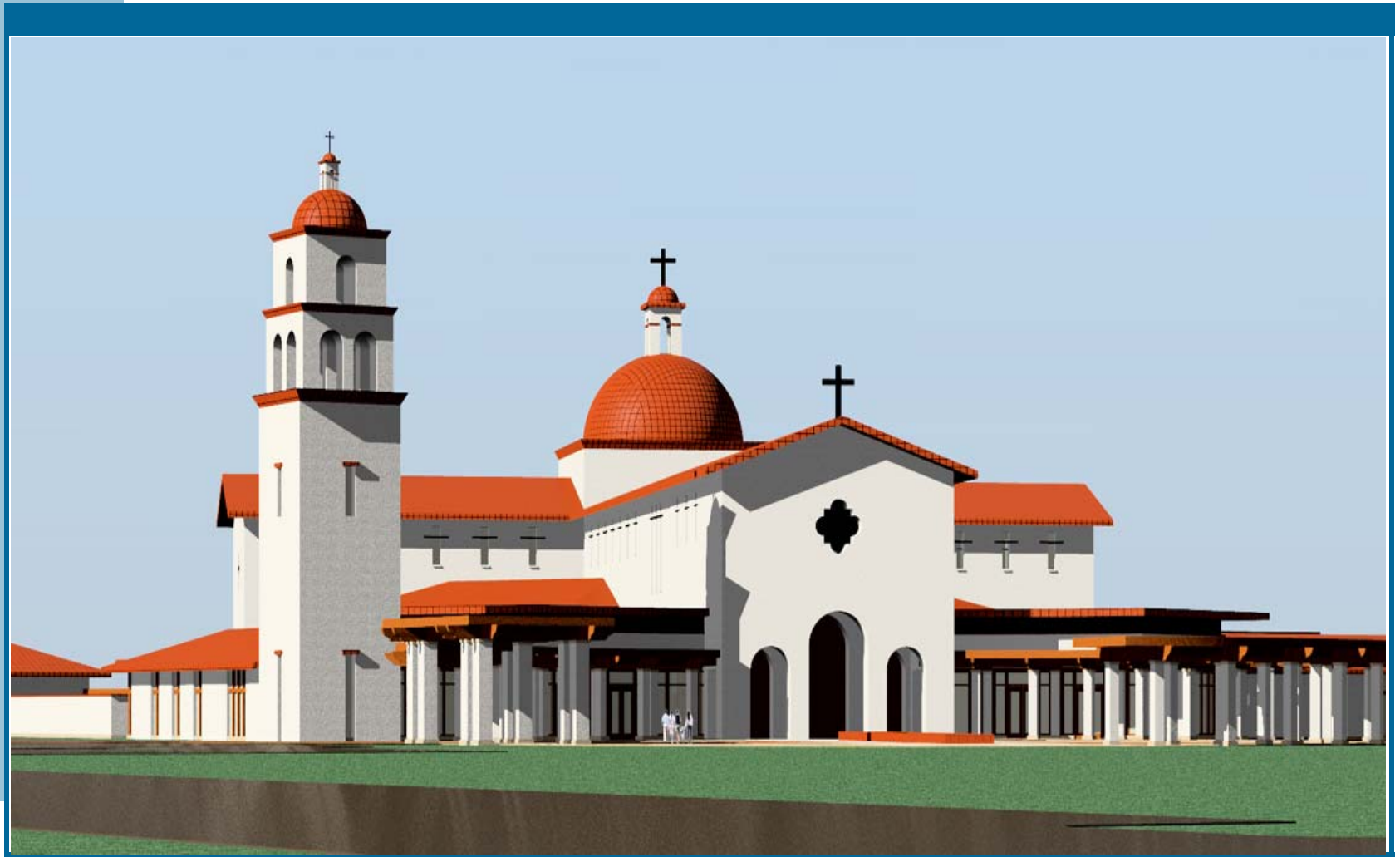

## Highlights Of Our Project—Site Master Plan

Several years ago the Stockton Diocese purchased 20 acres of land located at the southwest corner of Valpico and Corral Hollow Roads in Tracy. The new church in this prime location will become the “cornerstone” for all future development in the surrounding area.

As depicted in the site master plan graphic, the church, multi-purpose building and school all surround the plaza providing a sense of unity between the buildings. Factors such as protection from wind and sun, slope of the property and view from the corner of Valpico and Corral Hollow were all taken into consideration in the positioning of each of the buildings.

- Beautiful water feature located at the heart of the plaza.
- Tastefully landscaped utilizing plants that are appropriate to our climate.
- Landscaping designed to recycle rain water run-off.
- Stations of the Cross gardens surrounding the church.
- Parking for 700 cars built with church phase.
- 250 additional parking spaces to be built with school phase.
- Ample handicap parking with easy access located throughout campus.
- Lower field to serve as a storm water retention basin.
- Set-back for future street widening already incorporated into master plan.
- Drinking and irrigation water provided by domestic well. Sewer capacity and fire water being negotiated with city.
- Classrooms and offices surround church creating more privacy and allowing for protected meditation gardens.
- Perimeter of campus to be gated for added security.
- Location for on-site caretaker.

The main entrance to the beautifully landscaped campus will be off Corral Hollow Road. A drop-off area will be flanked by large columns and a covered colonnade providing a dignified entryway for both weddings and funerals.

There will be ample parking for almost 1000 vehicles surrounding the campus. 700 spaces will be built with phase I, followed by 250 spaces when the school is built during a later phase. Several parking lot entrances will allow for efficient exiting after mass.

With its meandering walkways, meditation gardens, water features, shade trees and grass areas, it is sure to be a campus that will be comforting to the mind, body and soul. It is a place where families can safely gather to reflect upon the Lord.

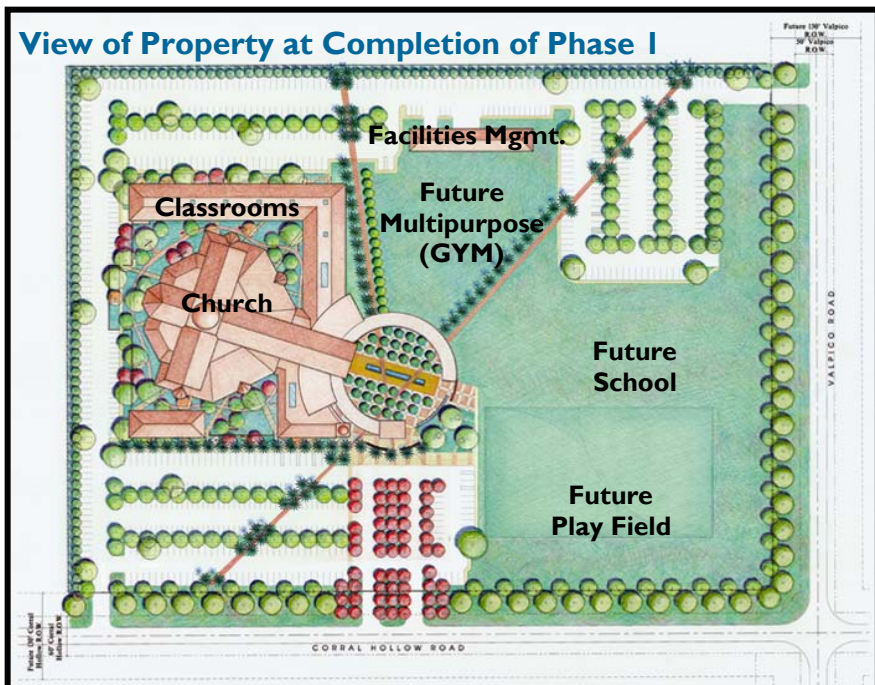

## Site Master Plan—At Completion of all Phases

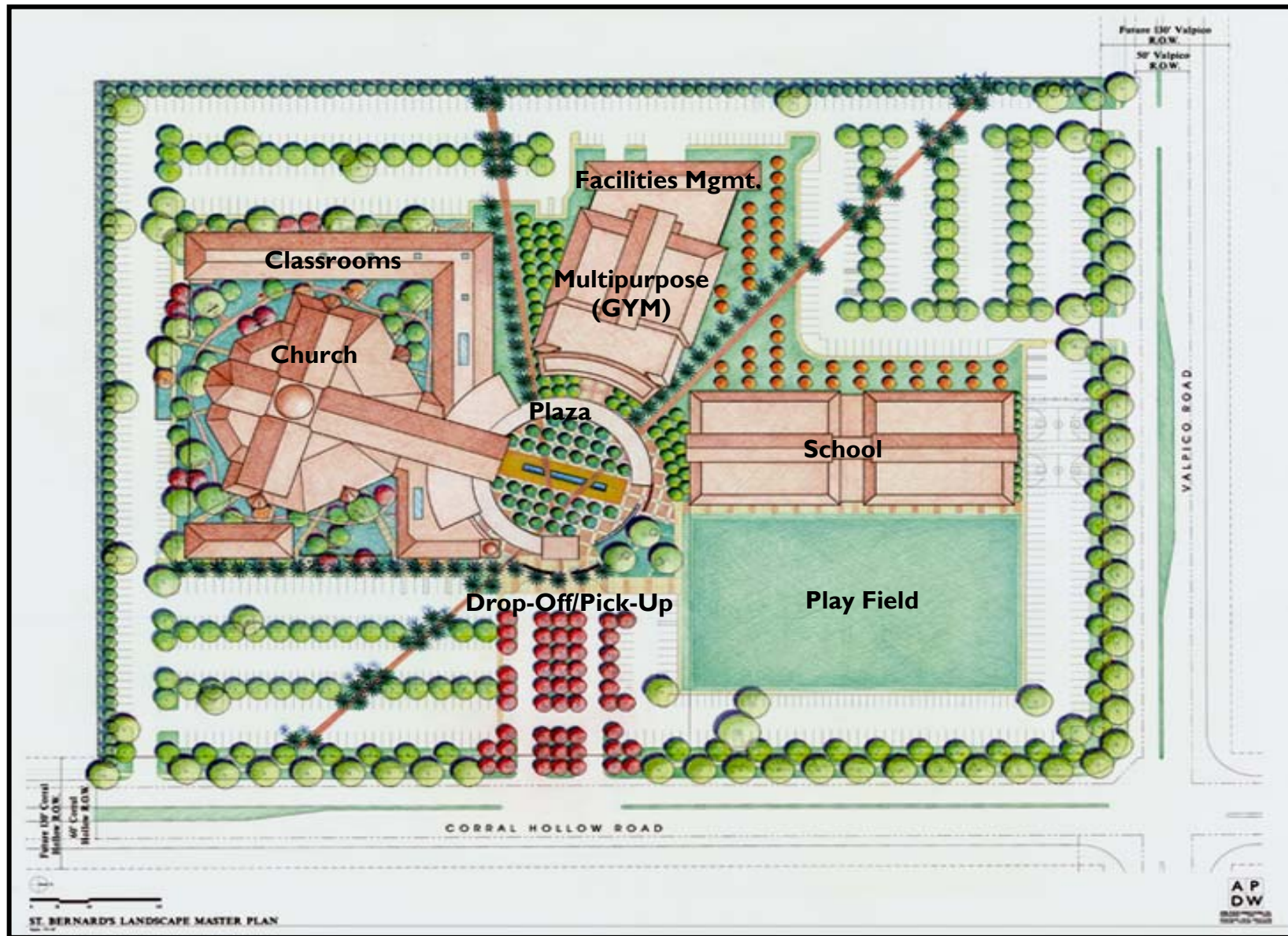

## Highlights Of Our Project—Church

- Seating capacity of 2000.
  - Large gathering area at entrance of church where families can comfortably gather to fellowship after mass.
  - All seating located at the front and side of altar to maximize visibility. No seating behind altar.
  - Distance of furthest pew not any farther than in our current church.
  - Gently sloping floors and wide aisles for easy access and maximum efficiency during communion.
  - Ample handicap seating located throughout with easy access.
  - Graceful arches, columns, and beamed ceiling.
  - Ample restroom facilities flanking both sides of gathering space.
  - Combined bereavement/brides room with private restroom.
  - State-of-the-art sound equipment and acoustics.
- Octagon shaped Reservation Chapel located at the rear of the altar providing a dignified location for our Lord.
  - Reservation Chapel will also have private entrance from outside rear of church.
  - Baptismal font at entrance of church, yet visible from inside.
  - Elevated altar with beautiful dome ceiling to enhance the Eucharistic celebration.
  - Four dedicated shrine areas.
  - Six Reconciliation Chapels located within shrine areas.
  - Visible choir area located to the left of altar.
  - Two parenting rooms with good visibility to altar. Each with private restroom.
  - Large classroom facilities for Sunday School, RCIA, etc.
  - Dedicated Nursery rooms.

**Artist's rendering  
looking down the  
Nave.**

**The interior ceiling  
will take the shape  
of a crucifix.**

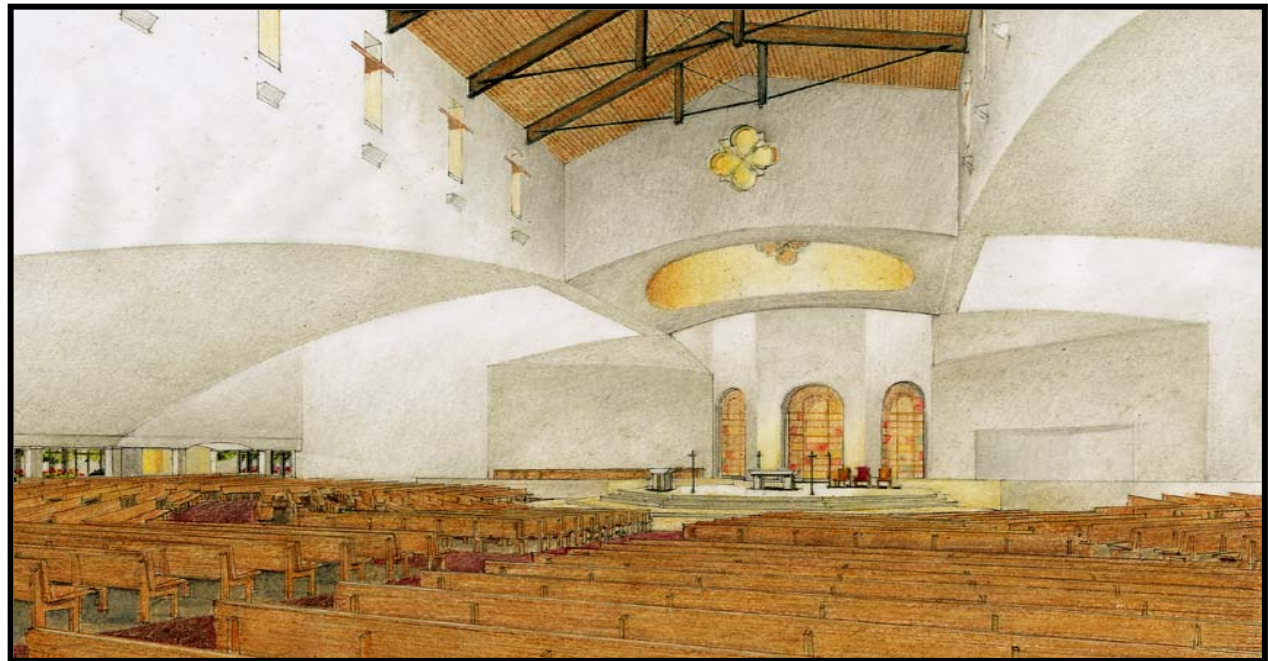

# Church Floorplan

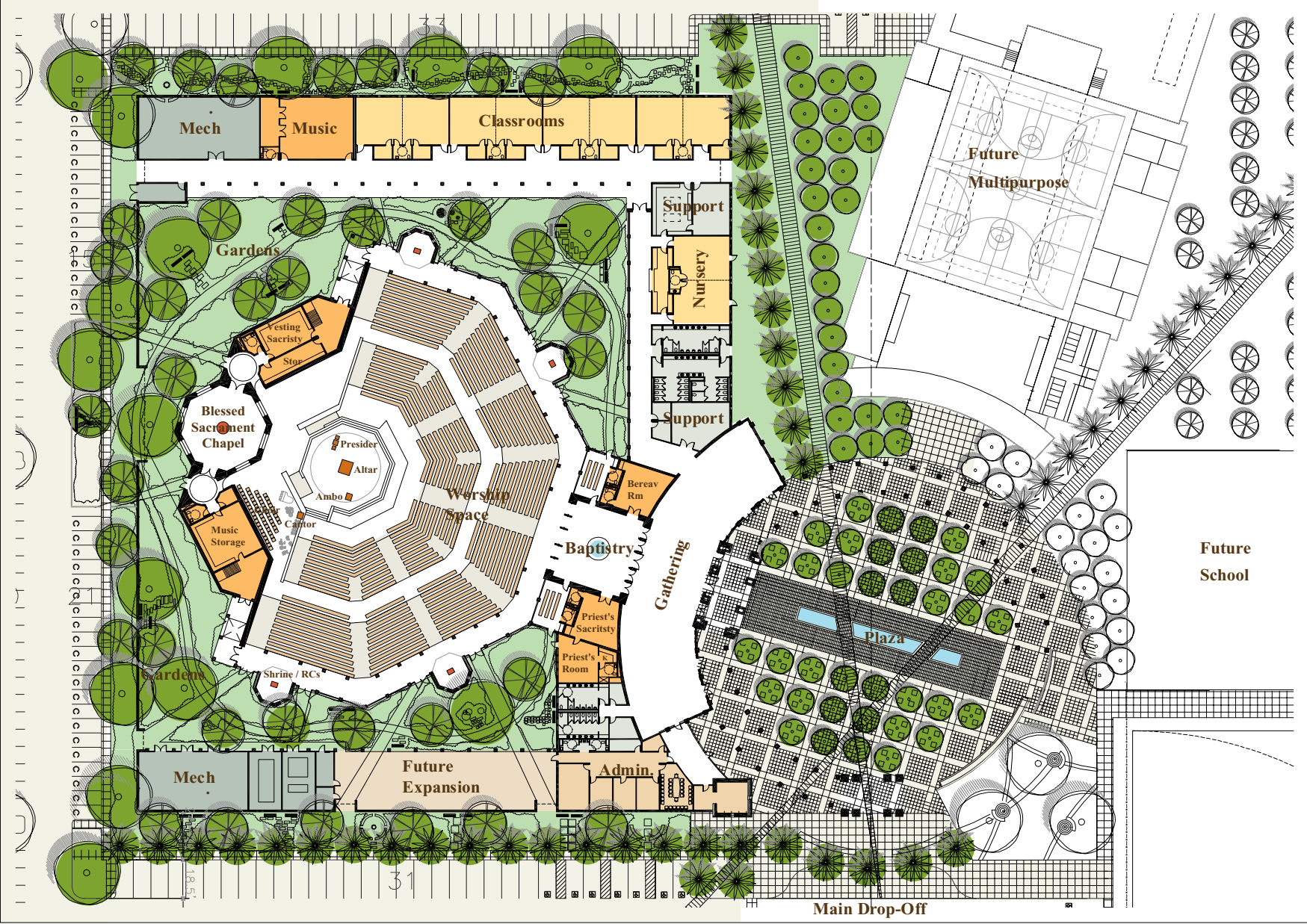

## Highlights Of Our Project

### Multipurpose Room (Gymnasium)

A comfortable and large space for social gatherings, meetings, sports, dining events, and student lunchroom.

- Two practice courts and one regulation court.
- Can be divided into three separate meeting and/or dining rooms with sound minimizing room dividers.
- Dining capacity for 1500 when all three rooms are opened.
- Separate lunchroom/cafeteria for school.
- State-of-the-art kitchen that is accessible to all three dining areas.
- Large barbeque area adjacent to main kitchen.
- Large stage area with state-of-the-art sound system and acoustics.
- Designated dining/meeting area that will not have “gym feel”.

### School

The proposed school is a Kindergarten through 8th grade school with two classrooms per grade, plus a preschool. The school is depicted on the master plan as two levels. This is necessary to maximize space and allow for greater efficiency.

The specific details of the school have not yet been completed, however, this facility will have state-of-the-art classrooms and the latest technology, including a science and computer lab, media center, and library. The structure will be efficient, functional, and safe. It’s architecture will complement the mission style influence of the surrounding church and multipurpose room.

There will be multiple playgrounds to accommodate the different age levels and physical levels of the children. The drop-off and pick-up process will be designed for safety and efficiency.

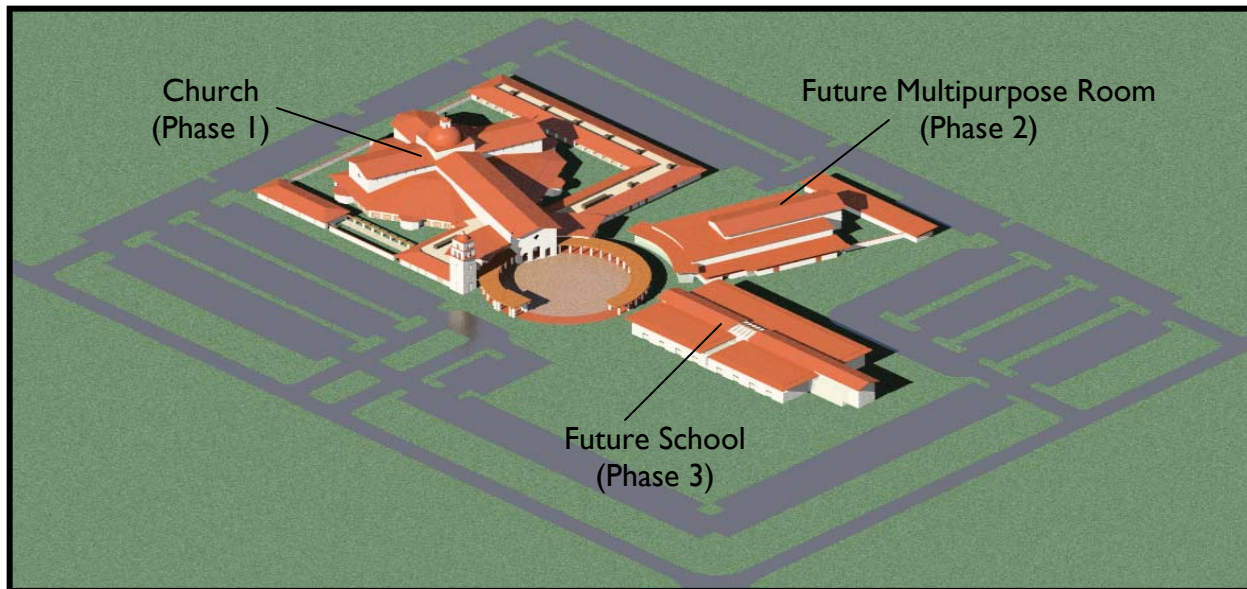

*Aerial view of campus*

## Determining the Need and Scope of Project

Careful consideration, planning, and prayer went into the process determining the needs and scope of this project.

### Parish Input

- Four parish-wide meetings held in English and Spanish.
- Five “advisory” meetings held with over 100 leaders of our Catholic community.
- Needs analysis completed by parish staff and ministry leaders.

### Pastoral Analysis

- Remaining as one parish with two churches is a more efficient use of resources.
- Existing St. Bernard’s campus will remain as the pillar of our faith community. All facilities will be utilized.
- Does not require additional priests.
- One Pastor and one Administrator will oversee activities of both facilities.
- One faith formation committee will serve both locations.
- Once the school moves to its new location (phase 3), the current school facility on Eaton Avenue will become a Catechetical/Social Ministry Center, thus better meeting the needs of our youth and seniors.

### Economic Analysis

- Saving money in the long run by building one larger church versus several smaller ones.
- The cost to build increases every year.
- No duplication of staff.
- No additional property in Tracy owned by Diocese.
- Will accommodate increase in Catholic population for the next 20 years within Tracy, Mountain House, and Tracy Hills.

## Estimated Project Cost

It is important to remember that this project will be completed in 3 phases over the next 9 to 10 years. Each phase should last approximately three years and three consecutive Capital Campaigns will take place (depending on the need) to complete all phases of the project.

Listed below are the current costs associated with the Phase 1 building of the Church. Since Phases 2 and 3 may not be built for the next 5 to 10 years it would be premature to publish their estimated cost.

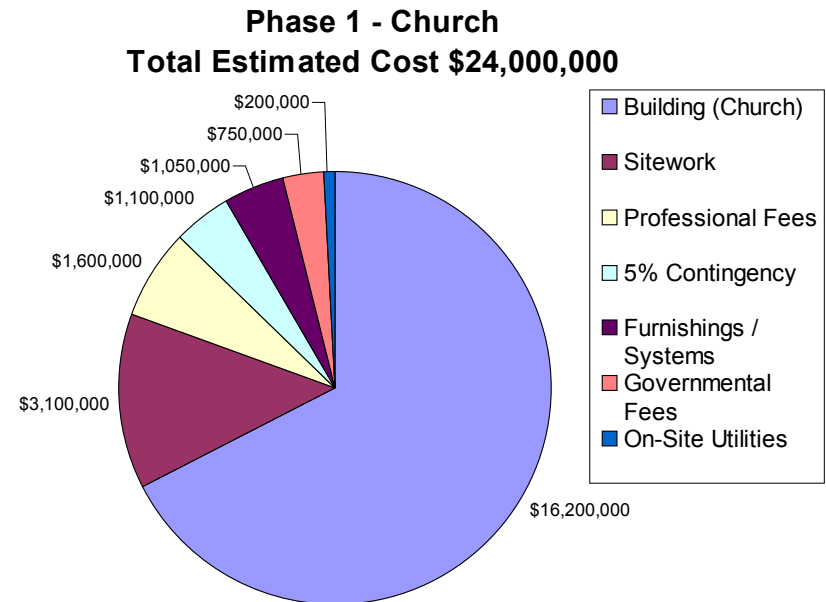

## Campaign Prayer

*Heavenly Father from whom every good gift comes, we thank you for the blessings bestowed upon our Catholic Community of St. Bernard's. We come before you with the needs and challenges we face together as a family. Help us grow as a community of faith and love, rooted in the faith of our parents and grandparents and looking ahead to serve the needs of our children and of future generations. Fill our hearts with enthusiasm and generosity to continue building your kingdom—a kingdom of justice, love and peace. We ask this through Jesus Christ our Lord who lives and reigns with you and the Holy Spirit, one God forever and ever. Amen.*



### Questions or Comments?

Email: [steeringcommittee@st-bernards.org](mailto:steeringcommittee@st-bernards.org)

Or call

209.835.4560 Office 209.835.4588 Fax

Internet: [www.st-bernards.org](http://www.st-bernards.org)

St. Bernard's Parish  
163 West Eaton Avenue  
Tracy, CA 95376

Published: March 2004